

J'SKIN

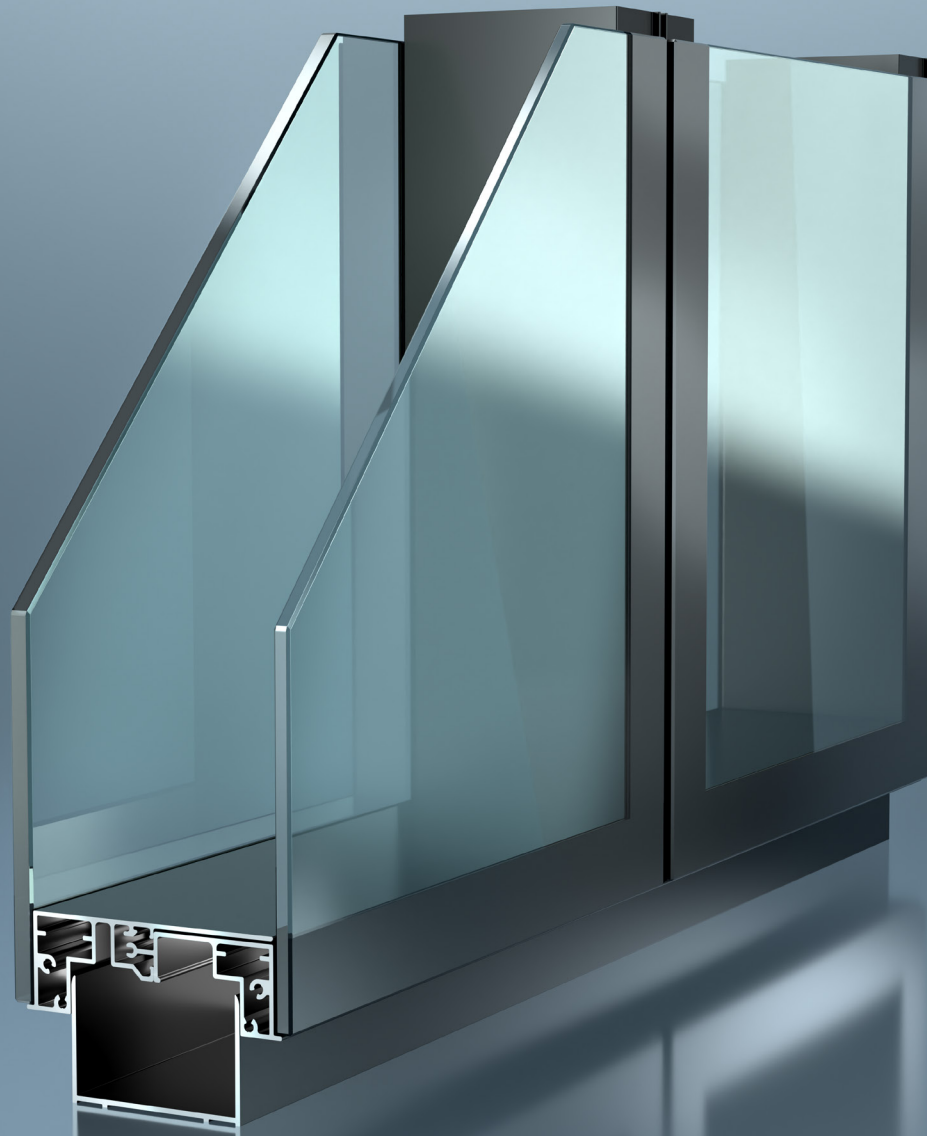

STRUCTURALLY,
SOUND.

Where unlimited modularity meets ultimate functionality and aesthetics! J'Skin is a double-glazed wall system that offers superior performance.

DOUBLE-GLAZED

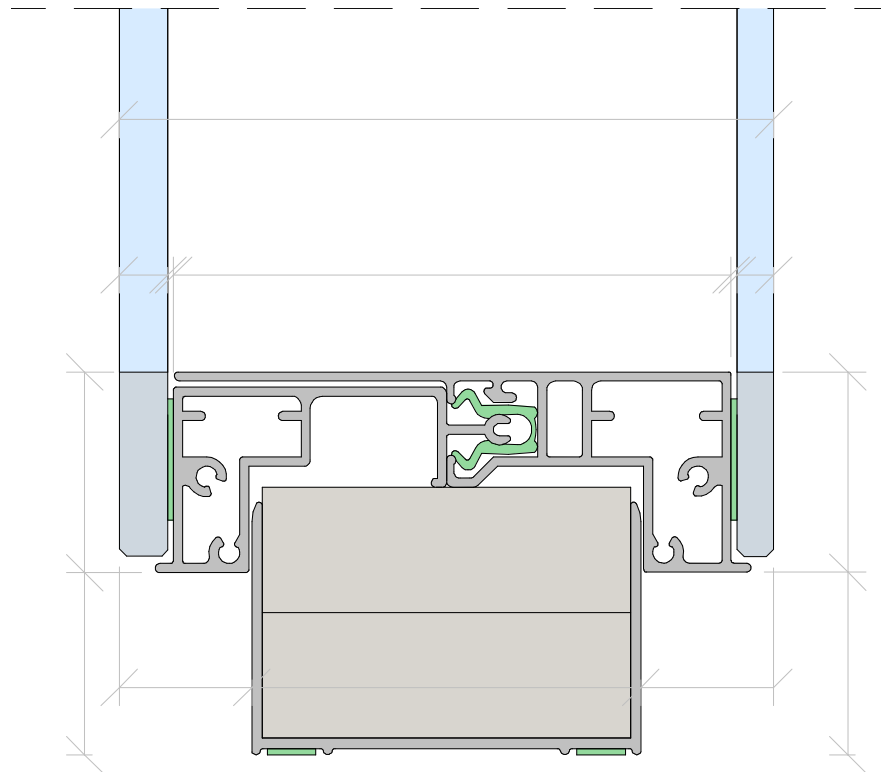

BASIC INFORMATION

	J'Skin 6-8 mm (1/4" - 5/16") tempered glass	J'Skin 6-8 mm (1/4" - 5/16") acoustically laminated glass
Acoustic performance (Rw)	40 dB	49 dB
Test report	016/2016-UAVE	0017/2015-UAVE
Profile dimensions (w x h)	108 x 33 mm (4 1/4" x 1 1/3")	108 x 33 mm (4 1/4" x 1 1/3")
Weight/m ²	46 kg	46 kg

TECHNICAL SPECIFICATIONS

Structure	
Ceiling track	Aluminium extruded profile
Floor track	Aluminium extruded profile
Material	Glass acoustically laminated or tempered 6 or 8 mm (1/4" or 5/16")
Joint type/width	Module to module connection is achieved with a 60x30mm (2 1/3" x 1 1/5") galvanized steel tube
Curved options	No

Wall details	
Profile finishings	Powder coating or anodization
Type of powder coating	Matte or gloss lacquer
Different colors	Black - RAL 9005 White - RAL 9010 (Any color on demand)
Tolerance	10 to 20 mm (3/8" to 13/16")
Wall thickness	108 mm (4 1/4")

METRIC

COMPOSITION WALL
CROSS SECTIONS

J'SKIN PANEL

E: 1/2

- 01 Acoustic Foam
- 02 U Profile
- 03 THB Glue tape 20 x 1 mm
- 04 6 mm glass
- 05 J'Skin profile
- 06 Nylon clip
- 07 8 mm glass
- 08 60 x 30 mm
galvanized steel tube
- 09 Leveler shim

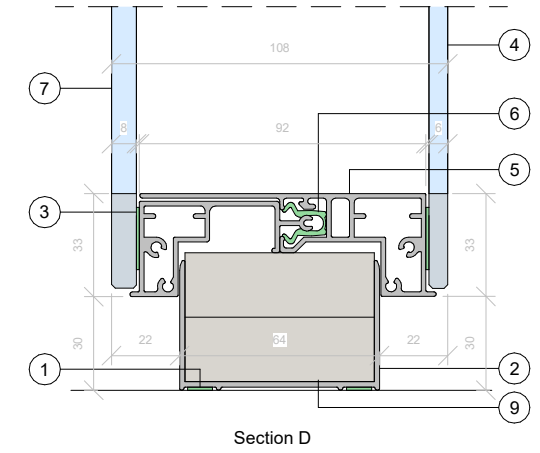
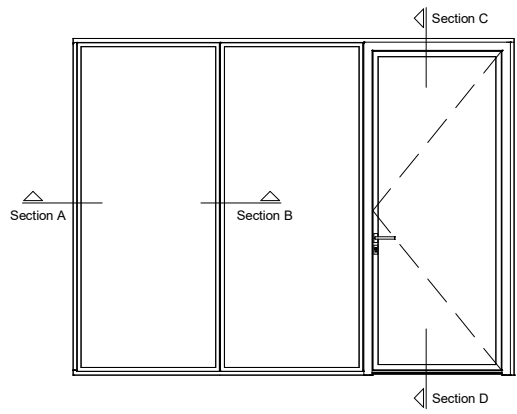
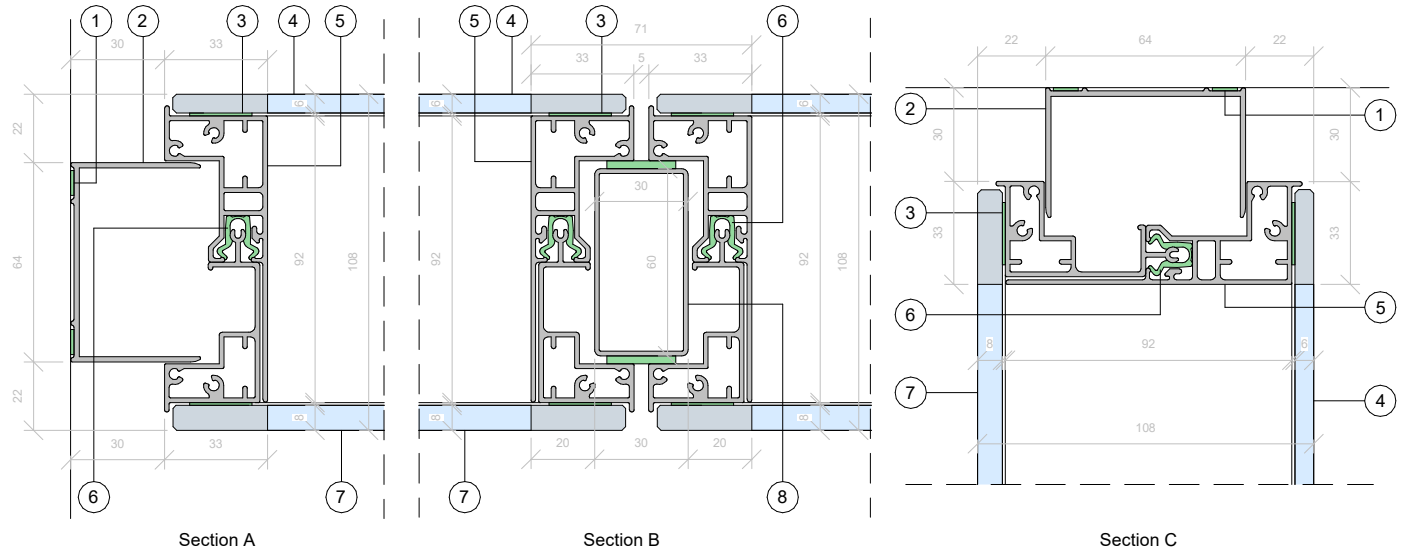

IMPERIAL

COMPOSITION WALL
CROSS SECTIONS

J'SKIN PANEL

E: 1/2

- 01 Acoustic Foam
- 02 U Profile
- 03 THB Glue tape 5 1/64"x1/32"
- 04 1/4" glass
- 05 J'Skin profile
- 06 Nylon clip
- 07 5/16" glass
- 08 2 1/3" x 1 1/5" galvanized steel tube
- 09 Leveler shim

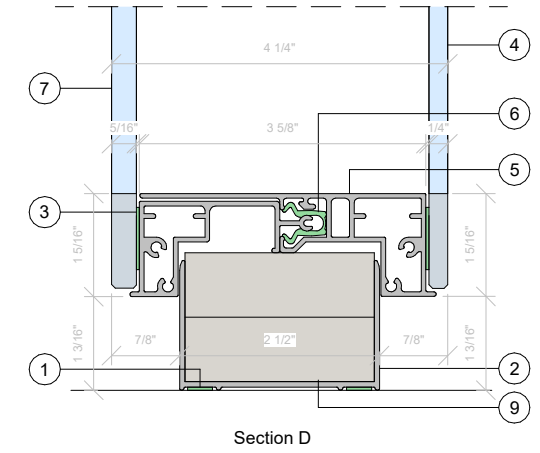
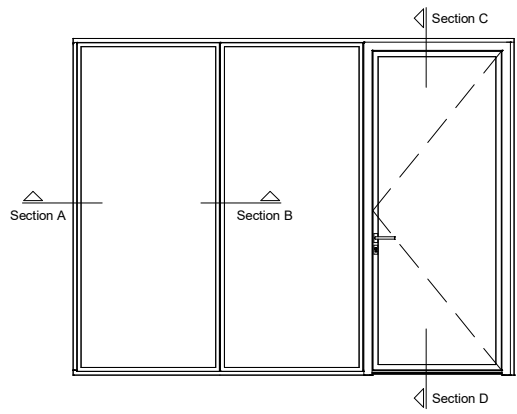
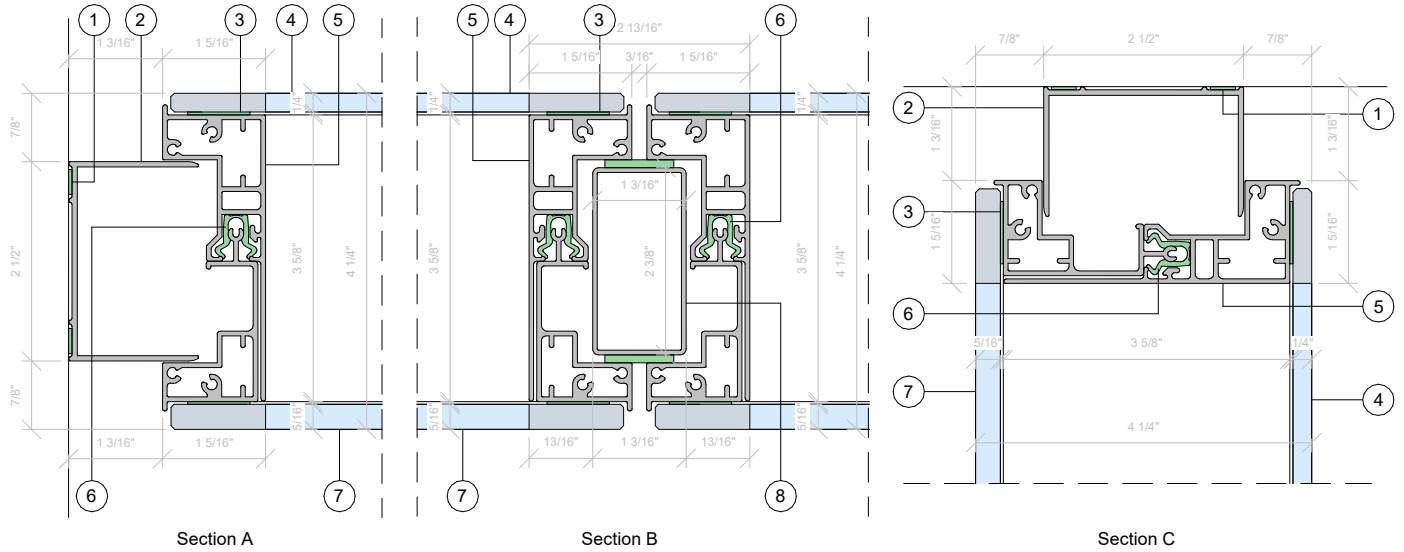

DOOR OPTIONS

DOOR	Acoustic value*	Possible?	Flush options?
J'Swing - Solid door 50 mm (2")		✓	1 side
J'Swing - Solid door 53 mm (2 1/6")		✓	1 side
J'Swing - Frameless single glazed door		✓	✗
J'Swing - Framed single glazed door 50 mm (2")		✓	1 side
J'Swing - Double glazed door 50 mm (2")	36 dB	✓	1 side
J'Swing - Glass skin door 108 mm (4 1/4")	36 to 42 dB	✓	2 sided
J'Swing - Solid door 108 mm (4 1/4")		✓	2 sided
J'Slide - Framed single glazed door 50 mm (2")		✗	✗
J'Slide - Double glazed door 50 mm (2")		✗	✗
J'Slide - Solid door 50 mm (2")		✗	✗

*The acoustic value is given when officially tested.



WWW.JANSENWALLSOLUTIONS.COM



INFO@JANSENWALLSOLUTIONS.COM



BE +32 11 79 92 00

PT +351 210 987 486